

## EBEZ® Feed Through Puck

Titan Division | Instruments

The Hunting EBEZ® Feed Through Puck (EBEZ) is a spring-loaded conductor contact installed inside the end fitting of wireline perforating guns. EBEZ simplifies the wiring process for selective fire perforating guns by eliminating the wire connection between each gun and the tandem sub above. The electrical connection is made by screwing the two assemblies together, saving assembly time and reducing wiring errors.

**Reduces amount of wiring required in the field.**

**Reduces service quality failures.**

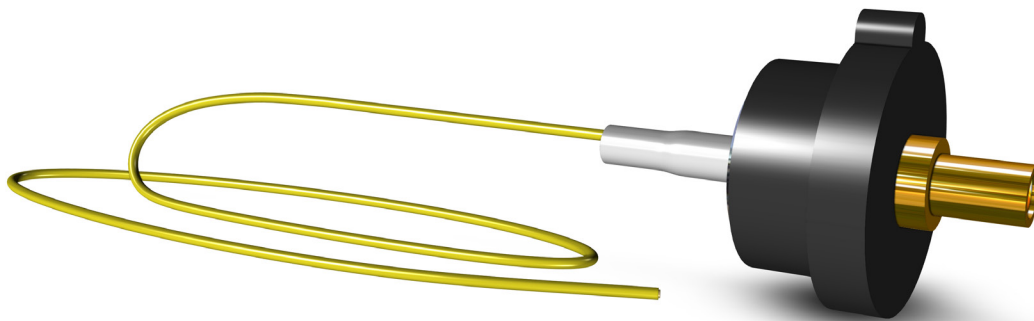

### Features

- ControlFire® and EBFire® compatible
- Spring-loaded contact receptacle
- Available prewired with double insulated wire

### Benefits

- Quick and easy installation
- Eliminates wiring between perforating guns in the field
- Cost effective
- Available for wireline gun sizes 2-3/4"-7" O.D.

## Specifications

Part Number	Description
9400-EBEZ-200	EBEZ Feed Thru Puck Assembly (9" wire)
9400-EBEZ-200-48	EBEZ Feed Thru Puck Assembly (48" wire)
9400-EBEZ	EBEZ Feed Thru Puck Assembly (no wire)
ControlFire® Components	
9002-013-120-1.8	ControlFire® Switch
DETO-CFA-A140F-T v1.8	RF-Safe ControlFire® Assembly with A140F Detonator
9400-EBTW-WG	EB Thru-Wire Pressure Bulkhead
9400-EBRN-WR	EB Grounding Retainer Nut
0363-000-389A*	3 1/8" EB Tandem Sub
9002-013-810-1	ControlFire® Shooting Panel
EBFire® Components	
9400-P-100-RNSB 350	P-100 Positive (+) RNSB Pressure Switch Retainer   350°
9400-P-100-RNSB 450	P-100 Positive (+) RNSB Pressure Switch Retainer   450°
9400-N-100-RNSB 350	N-100 Positive (+) RNSB Pressure Switch Retainer   350°
9400-N-100-RNSB 450	N-100 Positive (+) RNSB Pressure Switch Retainer   450°
9400-EBDD-****	Dual Diode Switch
0363-000-389A*	3 1/8" EB Tandem Sub

\*EBEZ compatible with Hunting wireline gun and tandem sub sizes 2-3/4" - 7" O.D.

\*\*Double insulated versions are available. For this option add -EE to the part number. Example: 9400-EBEZ-200-48-EE

\*\*\*\* Compatible with existing EBFire® Dual Diode Switches



RNSB Retainer Nut

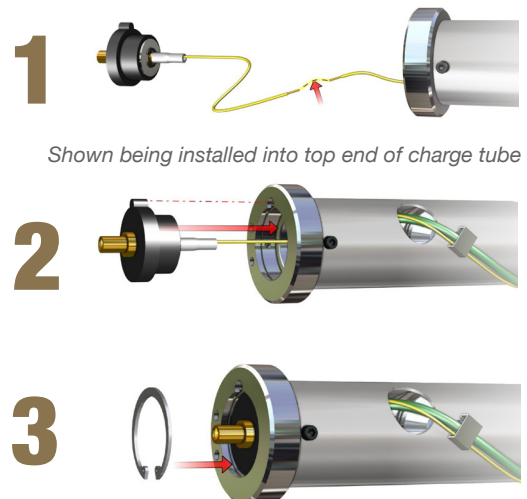

Shown being installed into top end of charge tube

For more information, contact your Titan Division sales representative today! Or visit us at: [www.hunting-intl.com/titan](http://www.hunting-intl.com/titan)

### Contact Information

**Sales**  
sales.titan@hunting-intl.com

**Support**  
support.titan@hunting-intl.com

**Perforating**  
Pampa, TX USA (806) 665-3781  
Oklahoma City, OK (405) 682-2680  
Monterrey, Mexico +52 (818)196-8700

**Instruments**  
Pampa, TX USA (806) 665-3781  
Wichita Falls, TX USA (940) 691-1005  
Houston, TX USA (713) 463-5881

**Energetics**  
Milford, TX USA (972) 493-2580

**Distribution**  
Hunting's distribution centers are strategically placed globally. For more information, visit us at: [www.hunting-intl.com/titan](http://www.hunting-intl.com/titan)