

Ditch Witch® Conversion Road Maps

Drill Rod (HIWS1 or HXT) (aka FS1 or FS2)

Drive Chucks

Saver Subs

Transition Rods / Starter Rods

Ditch Witch® JT5 / JT520 Conversion (HIWS1)

Component Road Map

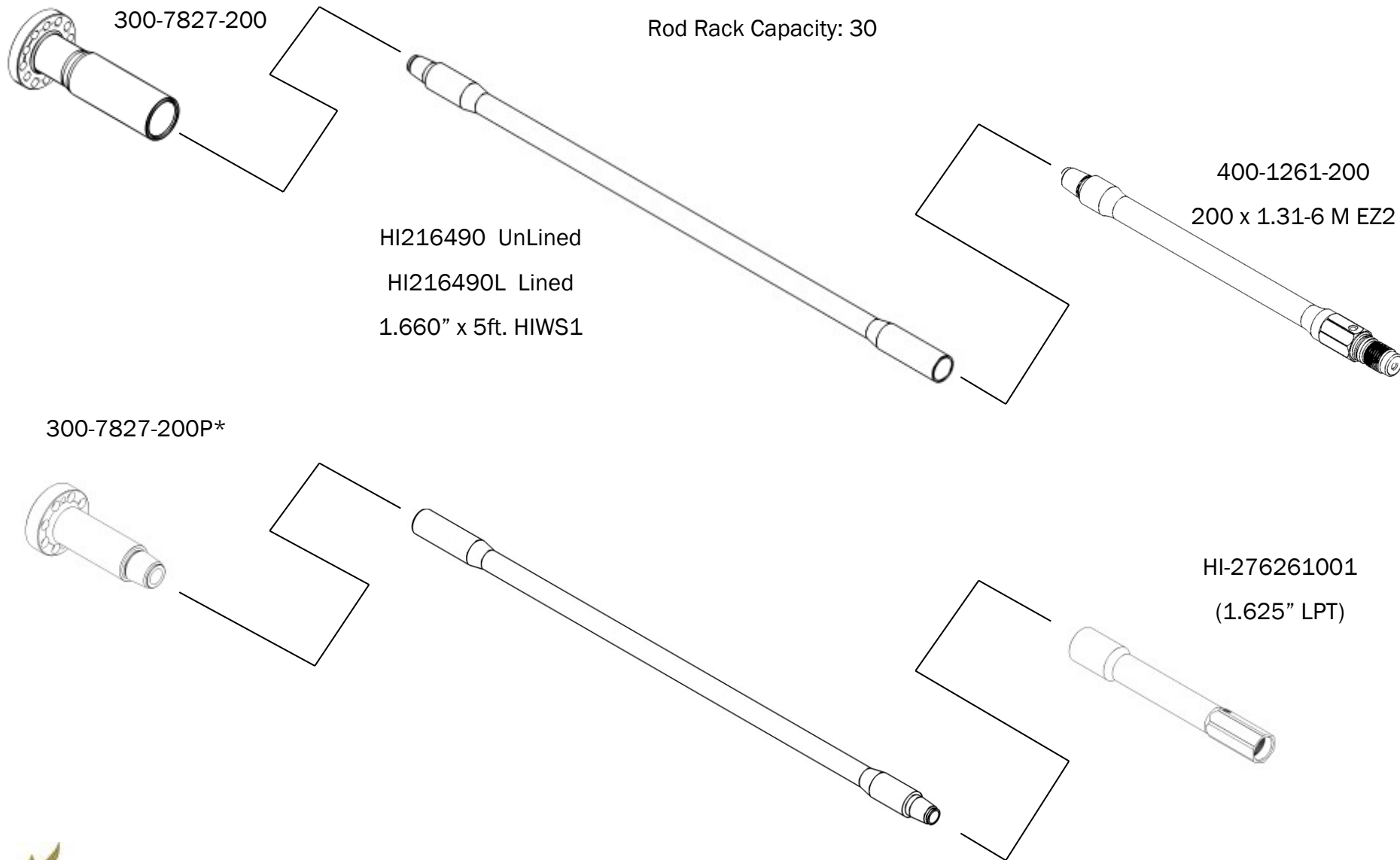

(*) indicates non stocking item

Ditch Witch® JT9 / JT10 / JT922 Conversion (HIWS1) Component Road Map

Rod Rack Capacity: 50

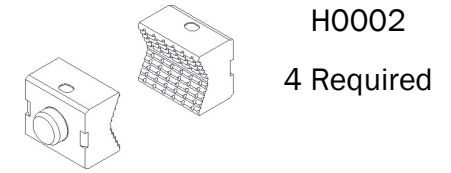

H0002
4 Required



One Piece: 300-7767-200
Recommended

Two Piece: 300-7767-200AS
Drive Chuck: 300-7767-200DC
Sub Saver: 296255351

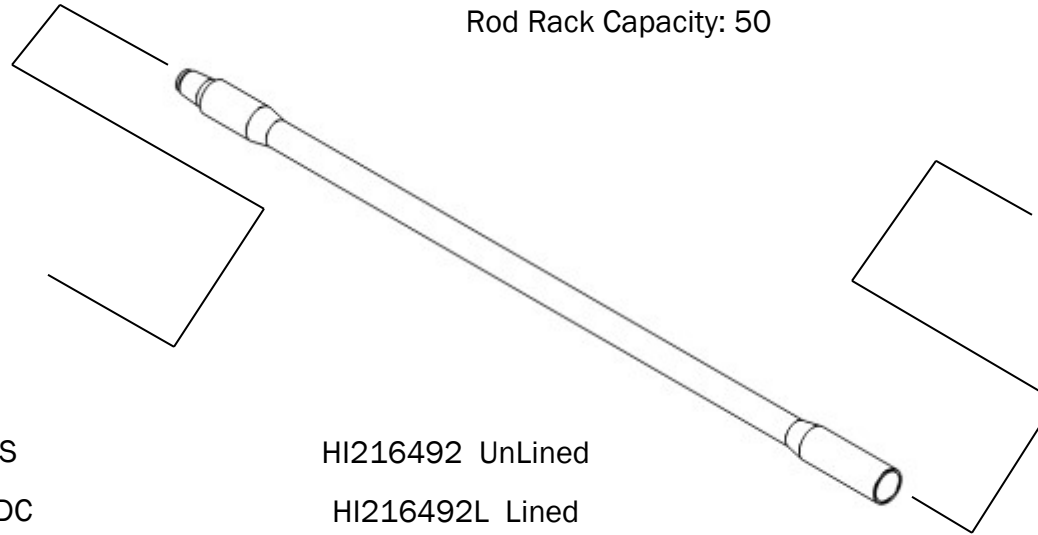

HI216492 UnLined
HI216492L Lined
1.660" x 6 ft. HIWS1
#200 Thread

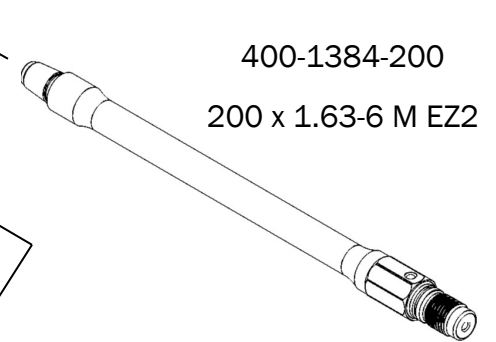

400-1384-200
200 x 1.63-6 M EZ2

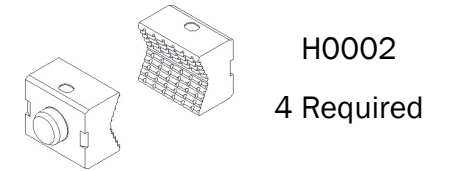

H0002
4 Required



One Piece: 300-7767-200P
Recommended

Two Piece: 300-7767-200PAS
Drive Chuck: 300-7767-200DC
Sub Saver: 300-7767-200PSS

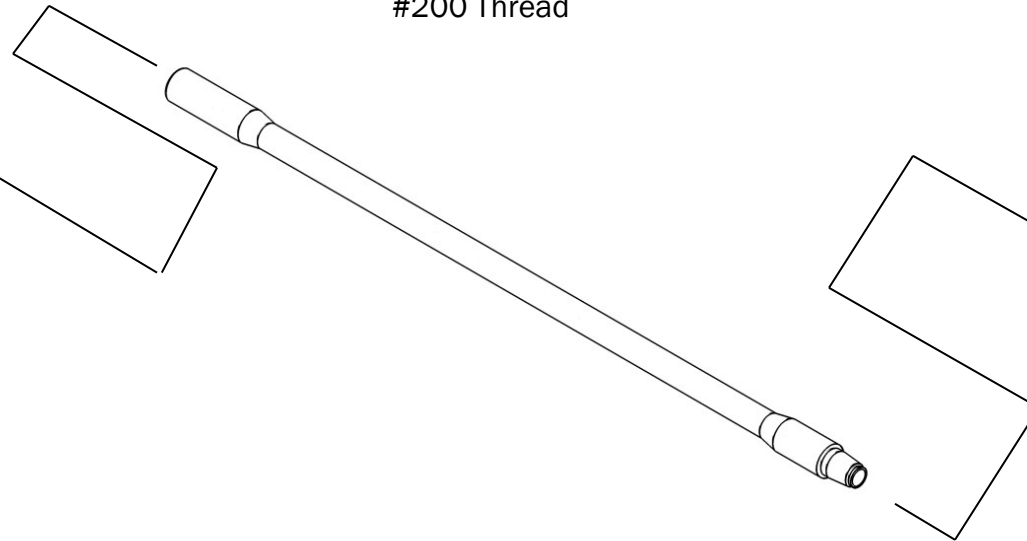

HI-276261001
(1.625" LPT)



Ditch Witch® JT1220 Conversion (HIWS1)

Component Road Map

Rod Rack Capacity: 40

400-604-400P

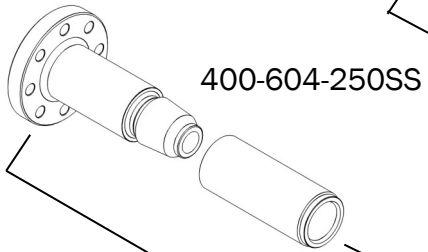

400-604-250SS

400-604-250AS

HI230993
1.900" x 10ft. HIWS1
#250 Thread

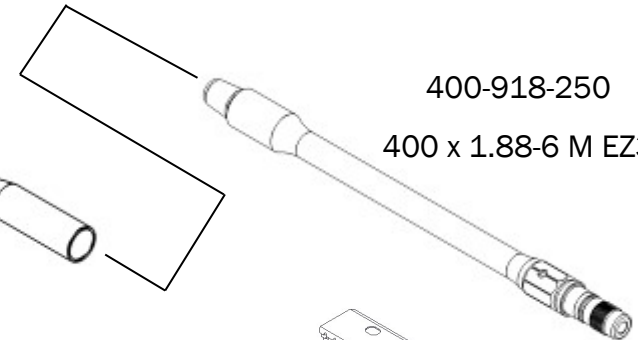

400-918-250

400 x 1.88-6 M EZ3

400-604-400P

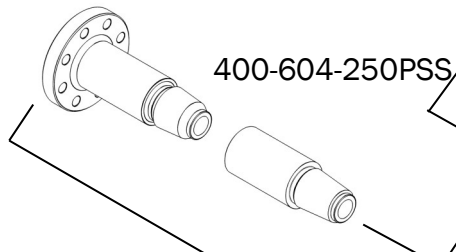

400-604-250PSS

400-604-250PAS

HI230993
1.900" x 10ft. HIWS1
#250 Thread

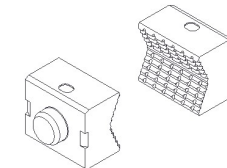

H0002

4 Required

HI234840001
(2.125" LPT)



Ditch Witch® JT1220 / JT2020 Conversion (HIWS1)

Component Road Map

Rod Rack Capacity: 40

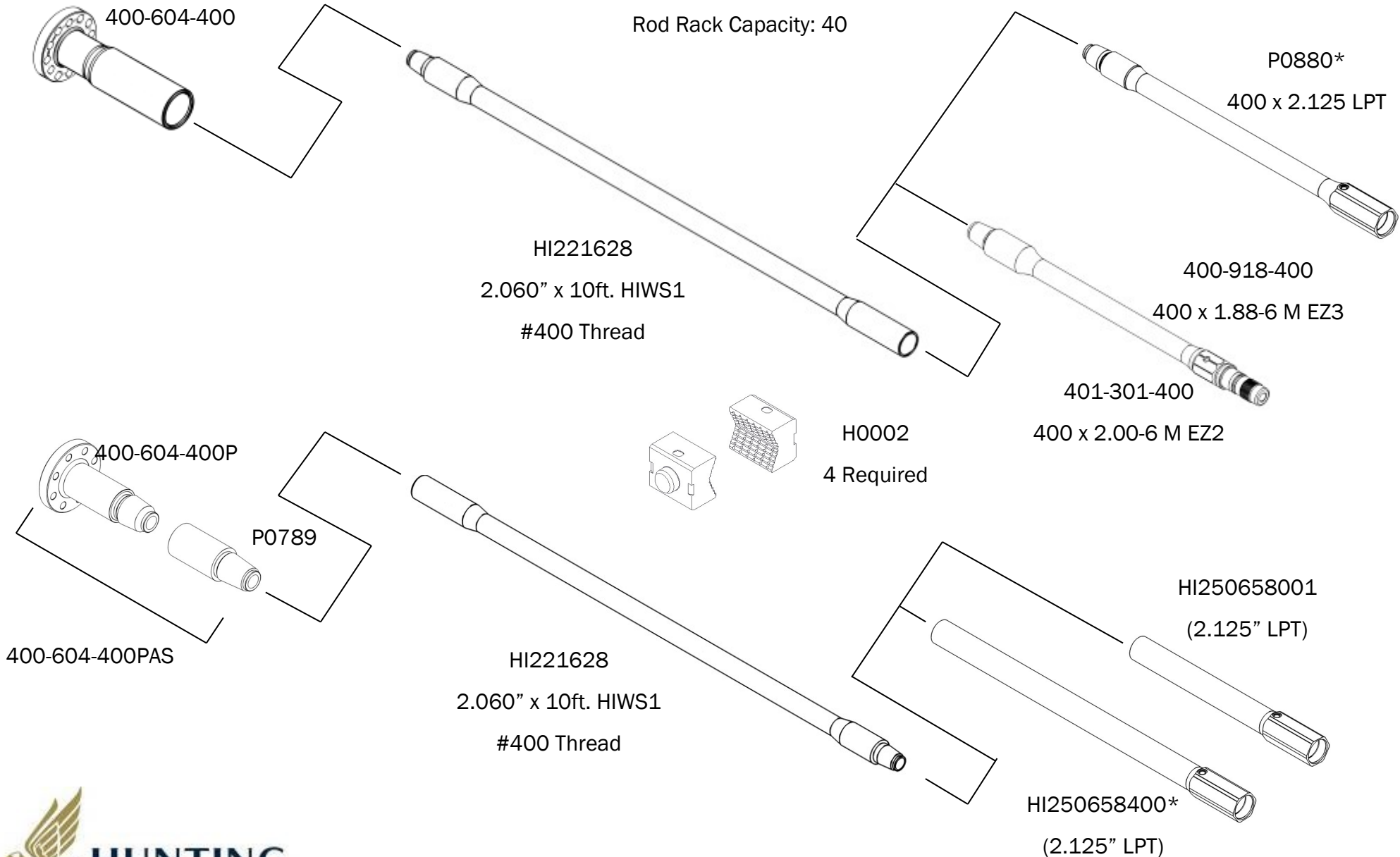

(*) indicates non-stock item



Ditch Witch® JT1220/JT2020 Conversion

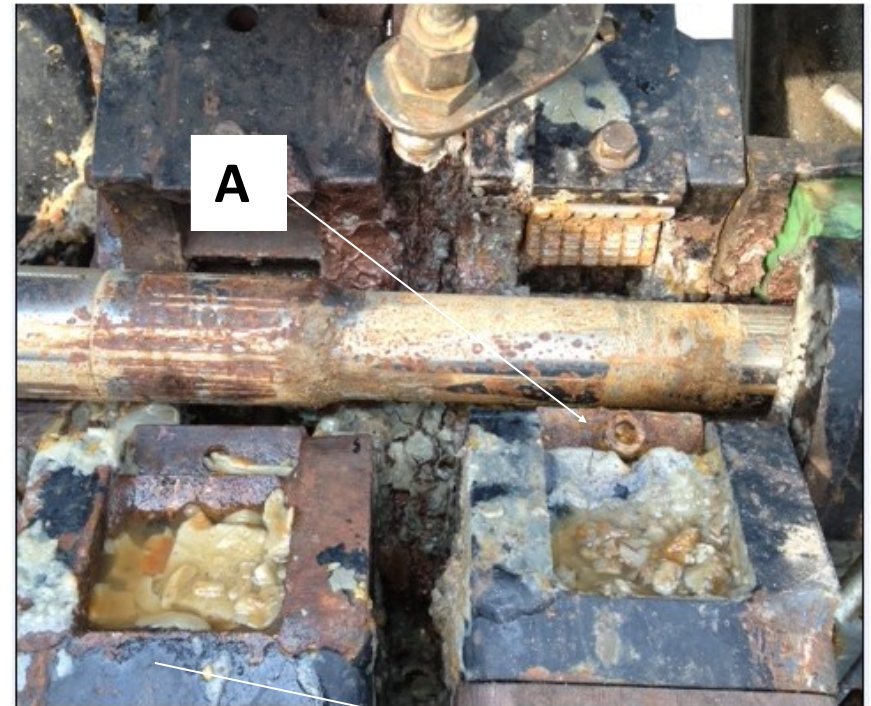
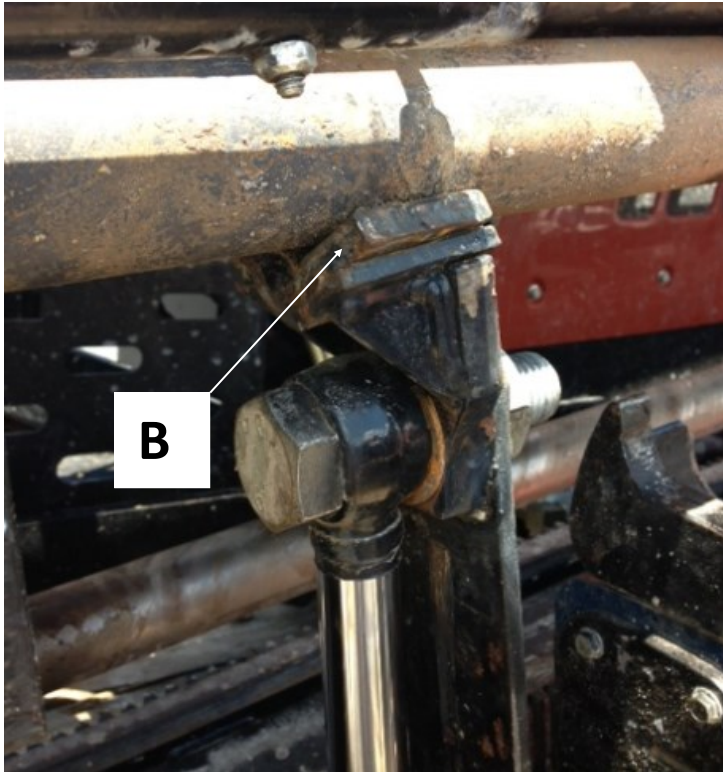

Additional items needed to complete conversion using HI221628 or HI230993 pipe.

-[A] A set of four jaw blocks for use with 2.25" or 2.125" tool joints (2.060" and 1.900" pipe). Jaw block can be purchased from Hunting part number H0002.

-[B] To account for the smaller diameter tool joint and lifting pipe into the rod-box, Hunting recommends welding 1/4" spacer plates on the two lift arms. (Required for JT2020 only)

-Note: Proximity sensors used in detection of pipe location for the rod loader functions may have to be repositioned slightly to account for the different diameter pipe.



Ditch Witch® JT2020 Conversion (2.060 pipe)



Additional items needed to complete conversion using HI221628 pipe.

-[C] The smaller OD tool joints stagger in the pipe loader guide area and will not allow a smooth transition into the rod box. Use 1/4" plate x 3" wide x 6-3/4" in length, bevel at both ends then stitch weld to inside of box dividers to create a smooth transition for the pipe. Material should be attached to the flat side (opposite operator side) of the guide area. (Required for JT2020 only)

-[D] Weld 3/8" spacer to catch arm to account for the smaller diameter pipe. (Required for JT2020 only)

Ditch Witch® JT20 Conversion (HIWS1)

Component Road Map

400-2254*
SaverLok® #400Box

Rod Rack Capacity: 40



HI221628
2.060" x 10ft. HIWS1
#400 Thread

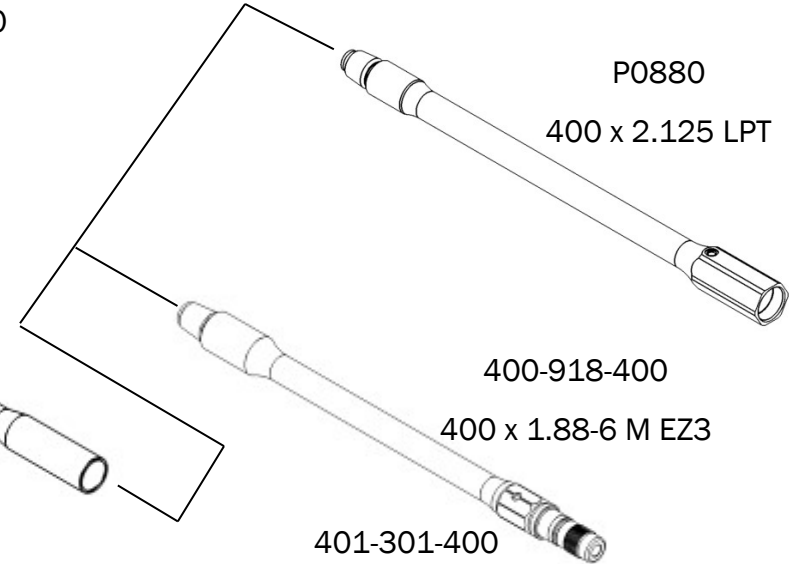

P0880

400 x 2.125 LPT

400-918-400

400 x 1.88-6 M EZ3

401-301-400

400 x 2.00-6 M EZ2

400-2255*
SaverLok® #600Box

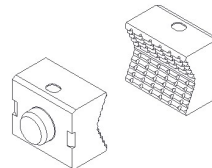

H0002
4 Required

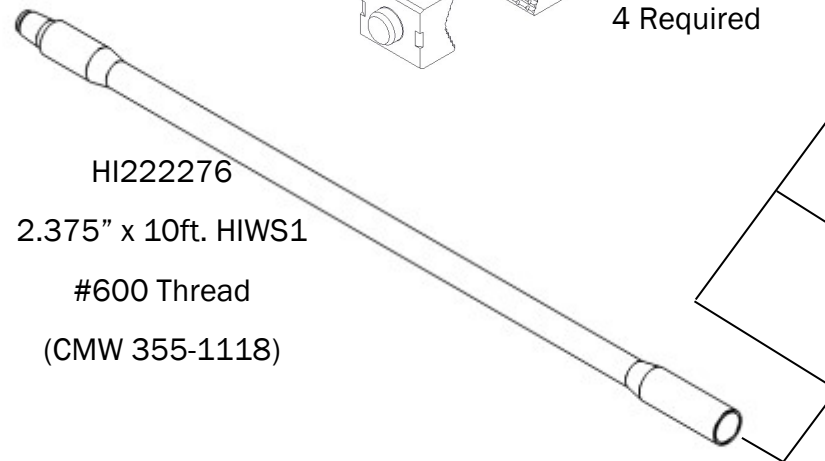

HI222276
2.375" x 10ft. HIWS1
#600 Thread
(CMW 355-1118)

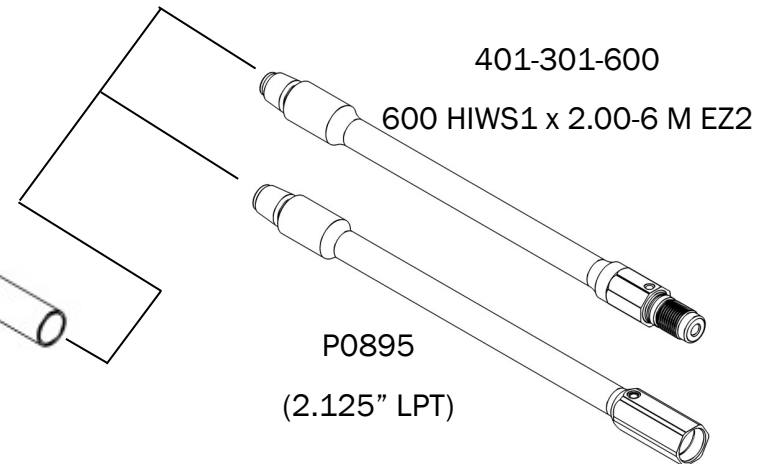

401-301-600

600 HIWS1 x 2.00-6 M EZ2

P0895

(2.125" LPT)



(*) indicates non-stock item

Ditch Witch® JT2020 Conversion (HIWS1)

Component Road Map

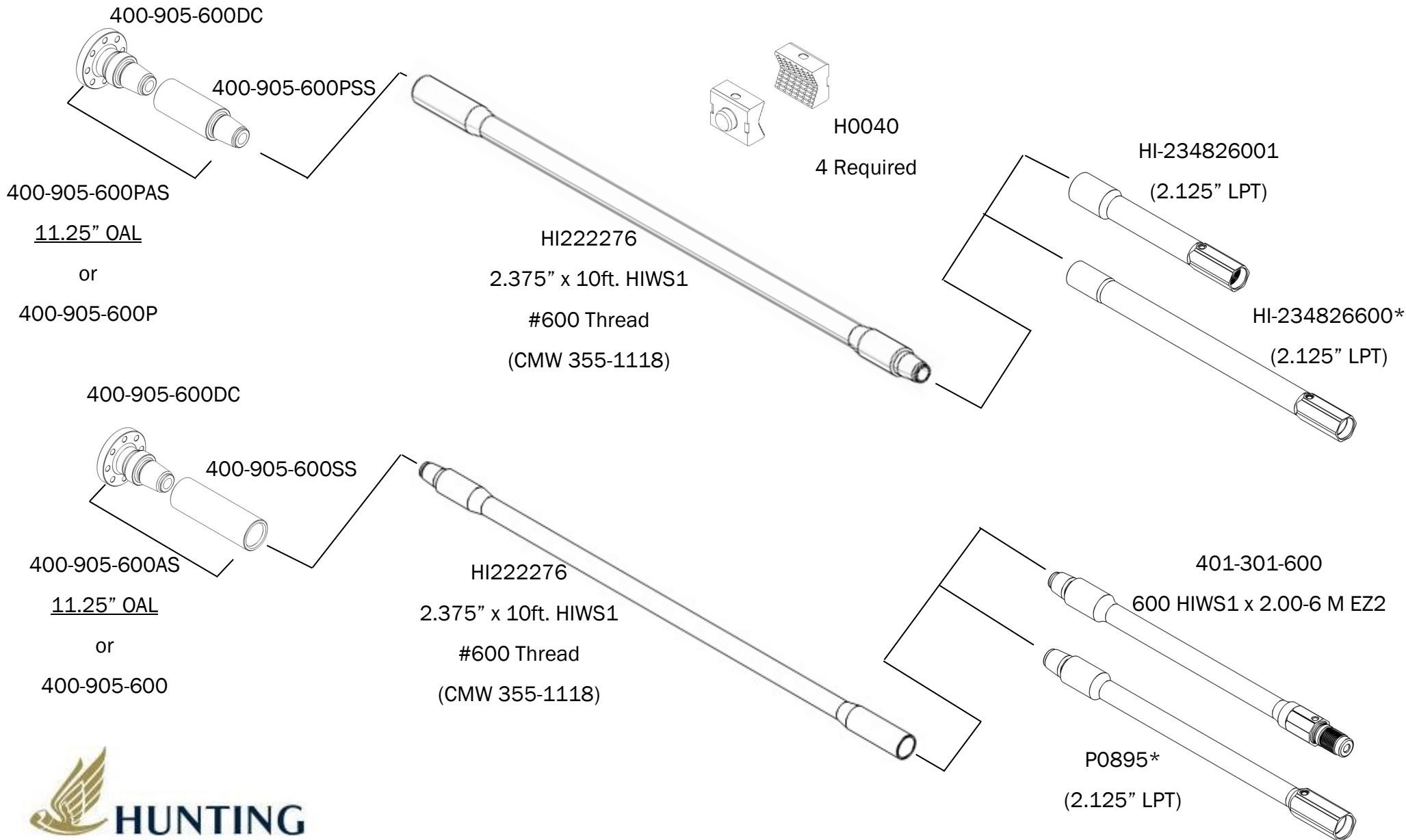

Ditch Witch® JT2020 Conversion (HXT)

Component Road Map

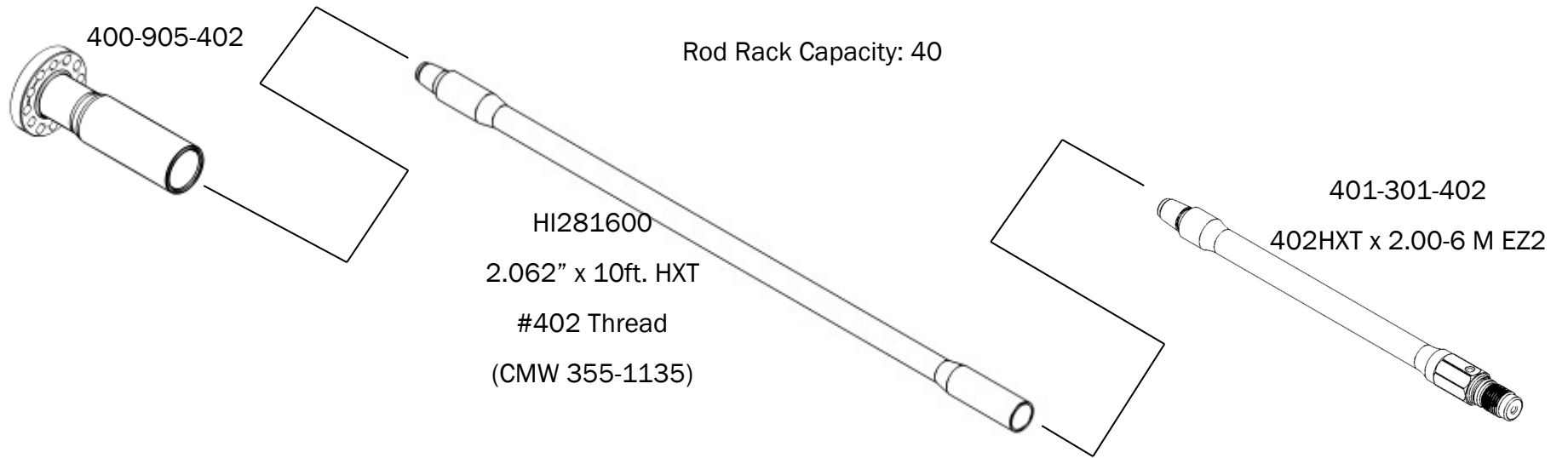

Ditch Witch® JT2720M1 Conversion (HIWS1)

Component Road Map

400-1224-602DC (5.75" Dia. Flange)

400-1229-602DC (7.50" Dia. Flange)

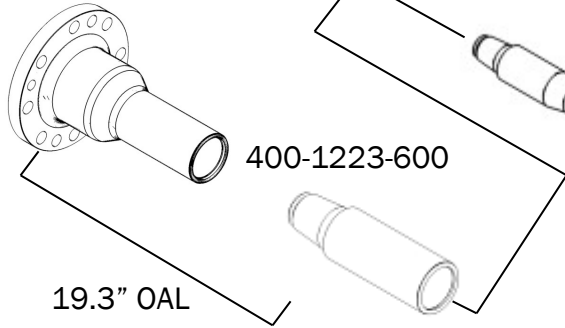

19.3" OAL

400-1223-600

400-1224-600AS (S/N 2W0001-2W9999)

400-1229-600AS (S/N 2X0001-2X9999)

400-1224-602DC (5.75" Dia. Flange)

400-1229-602DC (7.50" Dia. Flange)

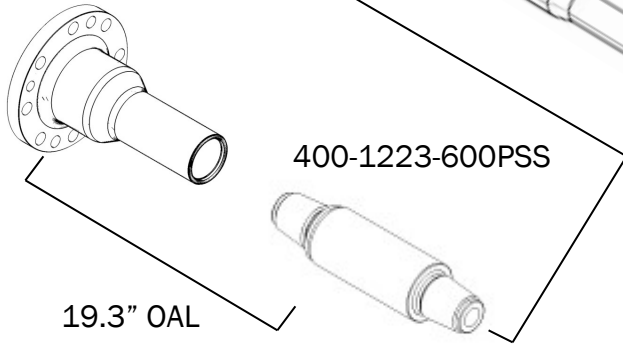

19.3" OAL

400-1223-600PSS

400-1224-600PAS (S/N 2W0001-2W9999)

400-1229-600PAS (S/N 2X0001-2X9999)

Rod Rack Capacity: 25/50

HI222276
2.375" x 10ft. HIWS1
#600 Thread

OR

HI222276
2.375" x 10ft. HIWS1
#600 Thread

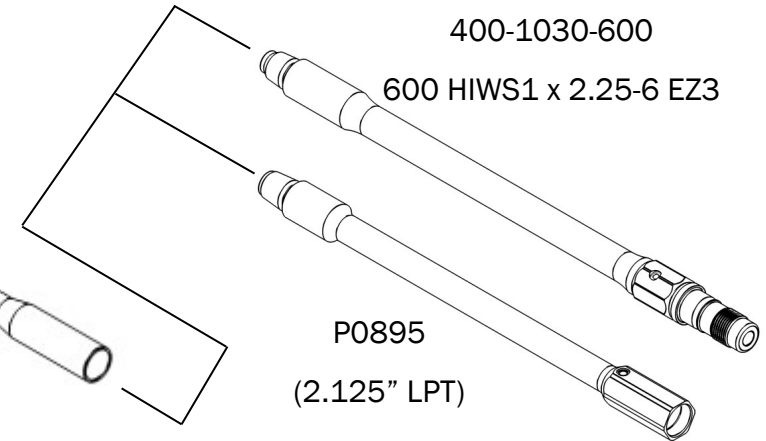

400-1030-600

600 HIWS1 x 2.25-6 EZ3

P0895

(2.125" LPT)

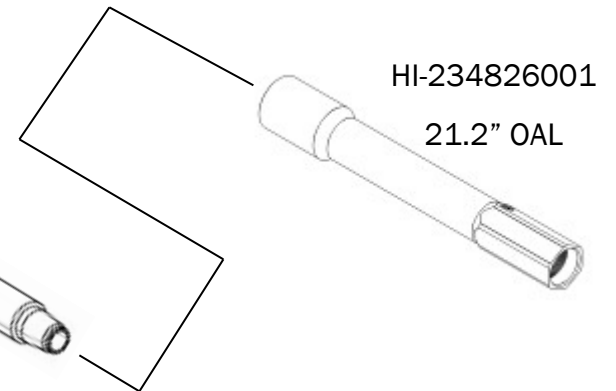

HI-234826001

21.2" OAL



Ditch Witch® JT2720M1 Conversion (HXT)

Component Road Map

Rod Rack Capacity: 25/50

400-1224-602DC (5.75" Dia. Flange)

400-1229-602DC (7.50" Dia. Flange)

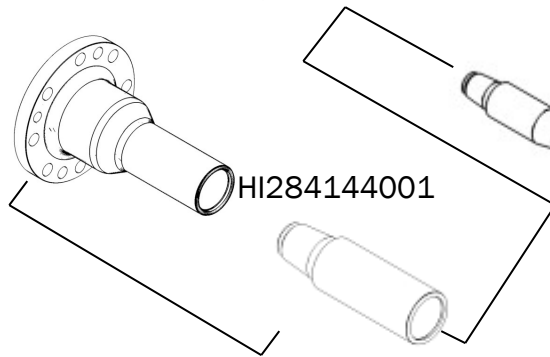

400-1224-602AS (S/N 2W0001-2W9999)

400-1229-602AS (S/N 2X0001-2X9999)

HI294566
2.375" x 10ft. HXT
#602 Thread

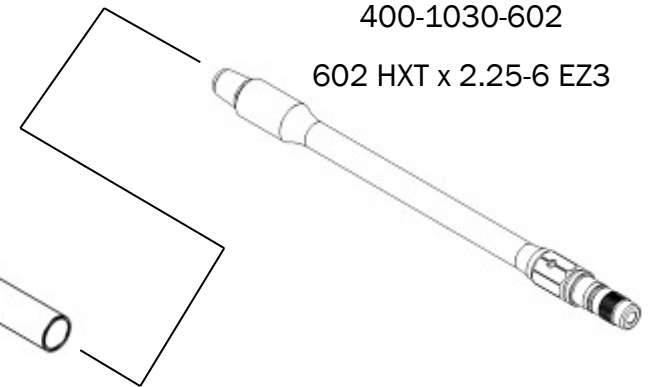

Ditch Witch® JT25 / JT30 Conversion (HIWS1)

Component Road Map

400-2037*

SaverLok® #600Box

Rod Rack Capacity: 50

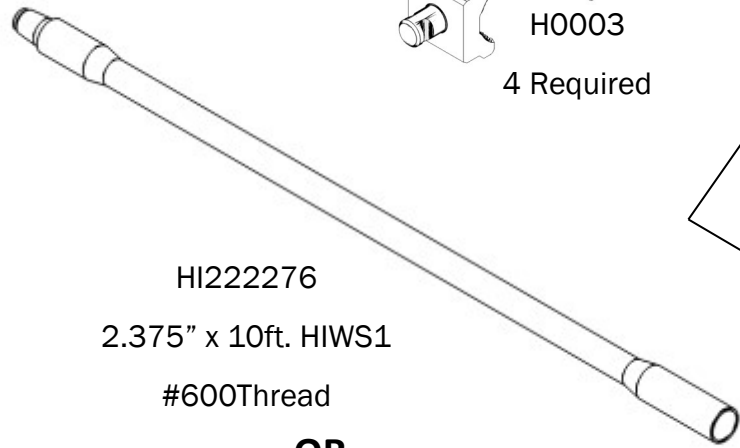
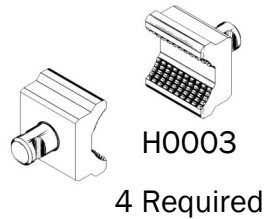

HI222276
2.375" x 10ft. HIWS1
#600Thread
OR

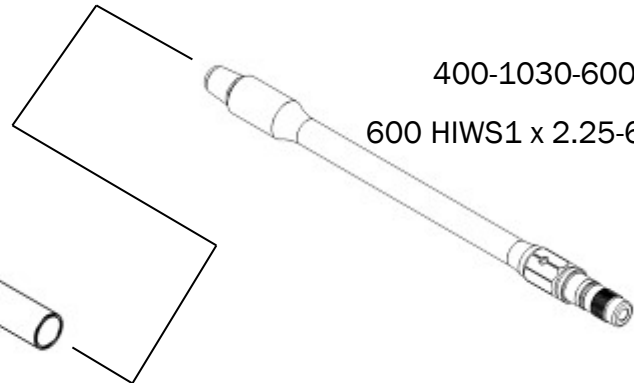

400-1030-600
600 HIWS1 x 2.25-6 EZ3



HI222276
2.375" x 10ft. HIWS1
#600 Thread

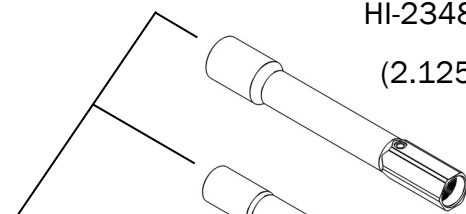

HI-234826001
(2.125" LPT)

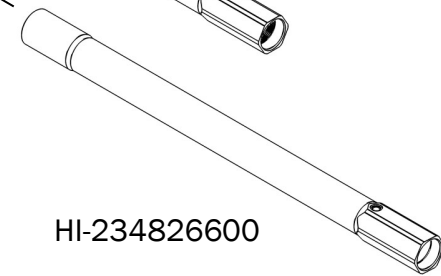

HI-234826600
(2.125" LPT)



Ditch Witch® JT25 / JT30 Conversion (HXT)

Component Road Map

CP0241-10*

SaverLok® #602 Box

Rod Rack Capacity: 25

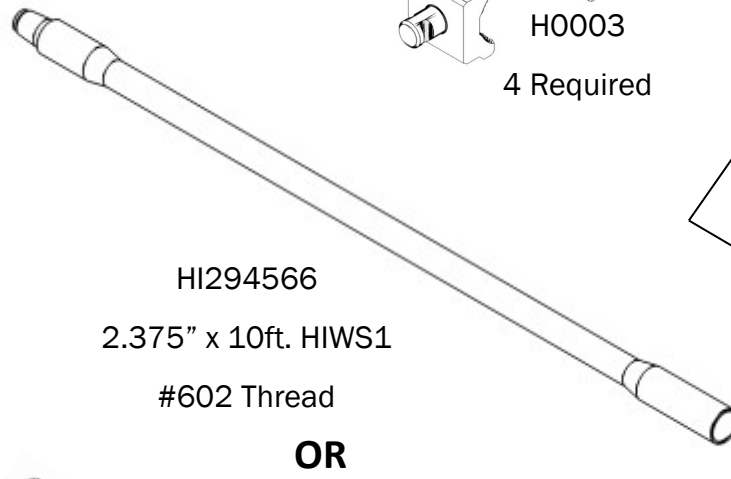
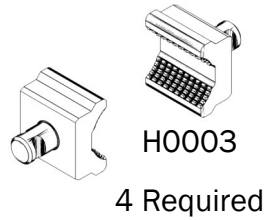

OR

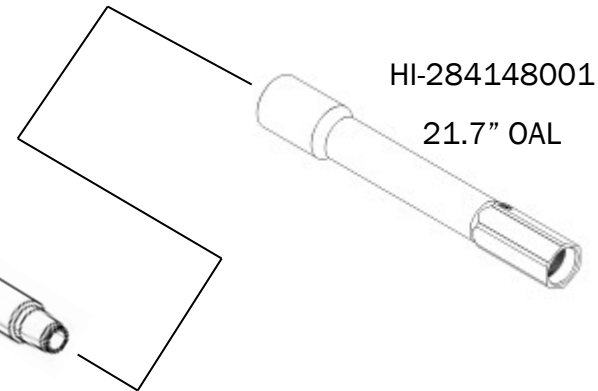
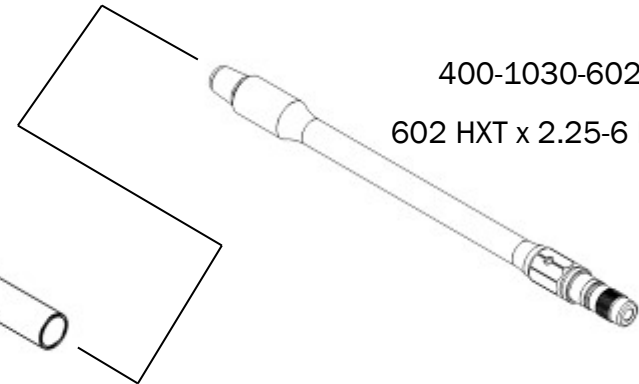
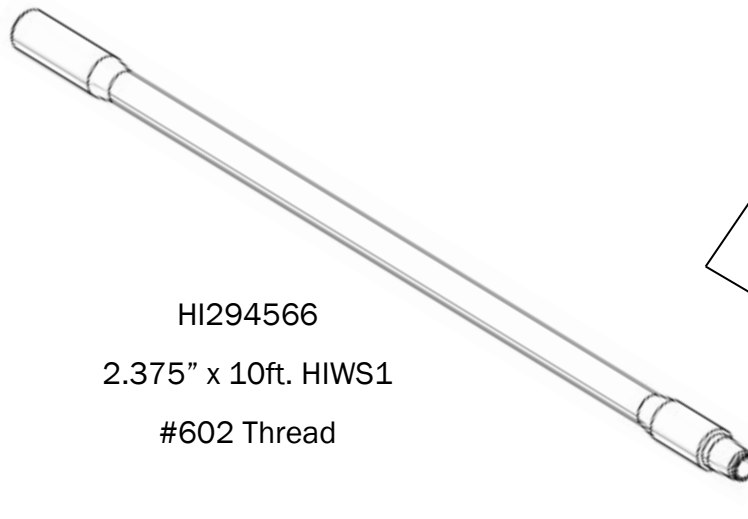

(*) indicates non-stock item

Ditch Witch® JT3020 Conversion (HIWS1)

Component Road Map

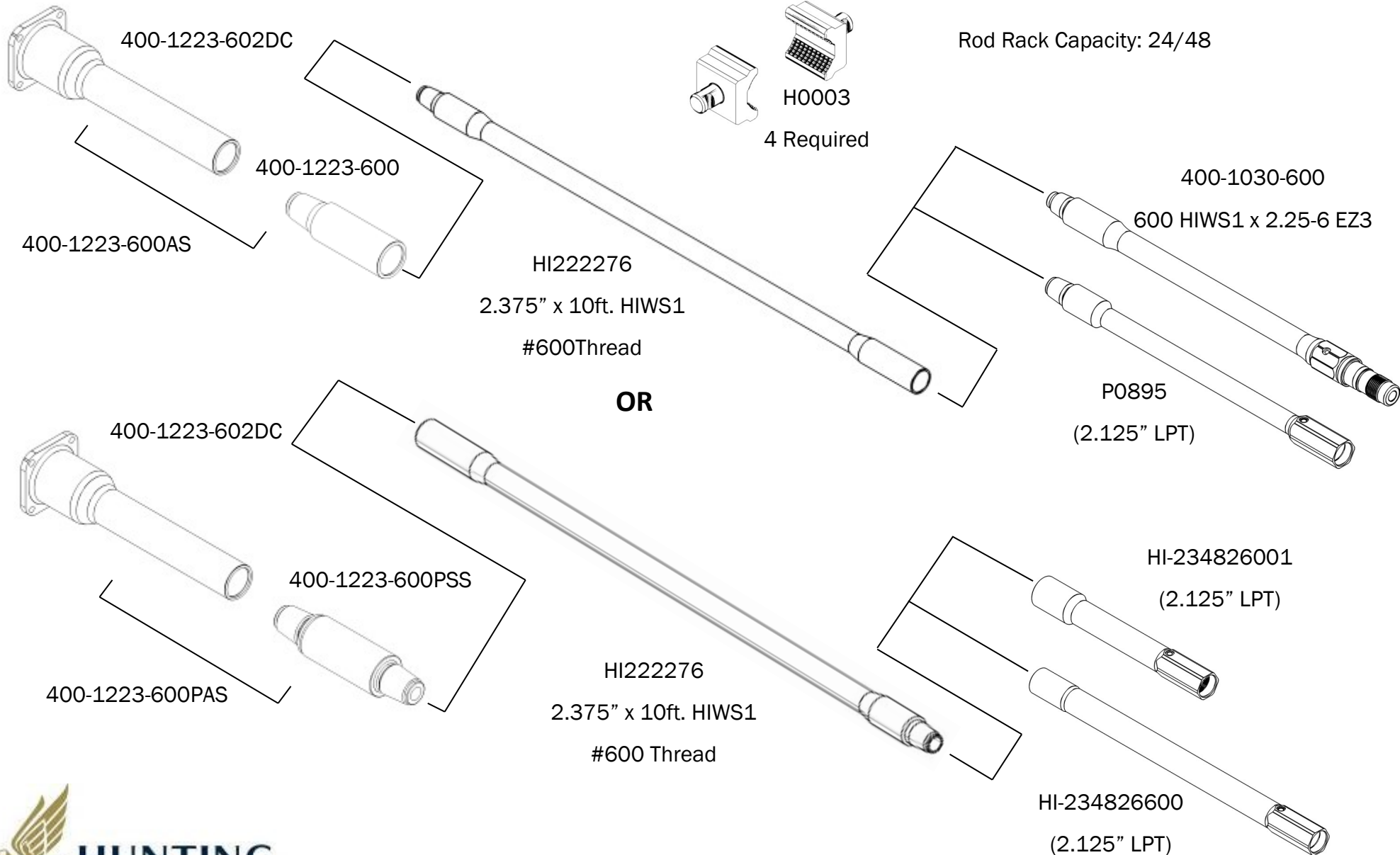

Ditch Witch® JT3020 Conversion (HXT)

Component Road Map

Rod Rack Capacity: 24/48

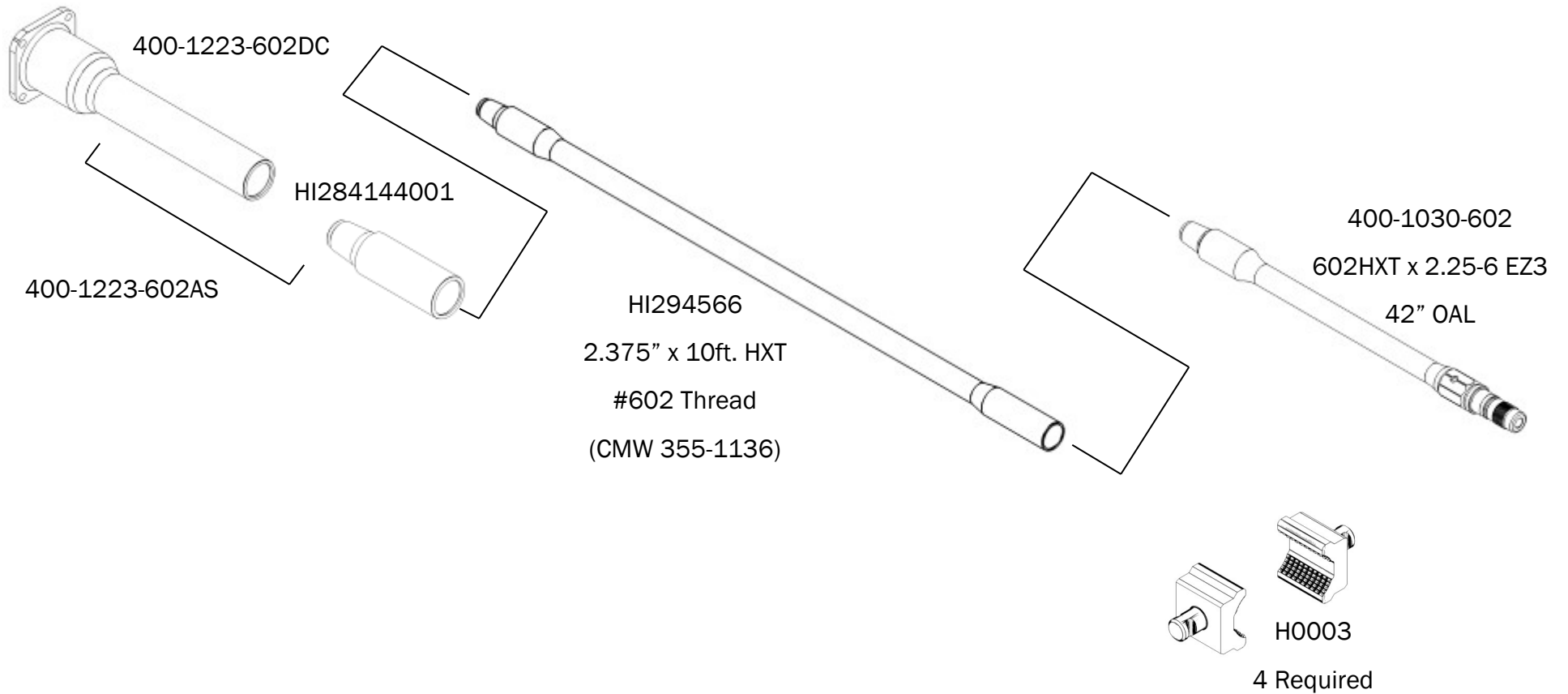

Ditch Witch® JT3020 Conversion (HXT and HIWS1)

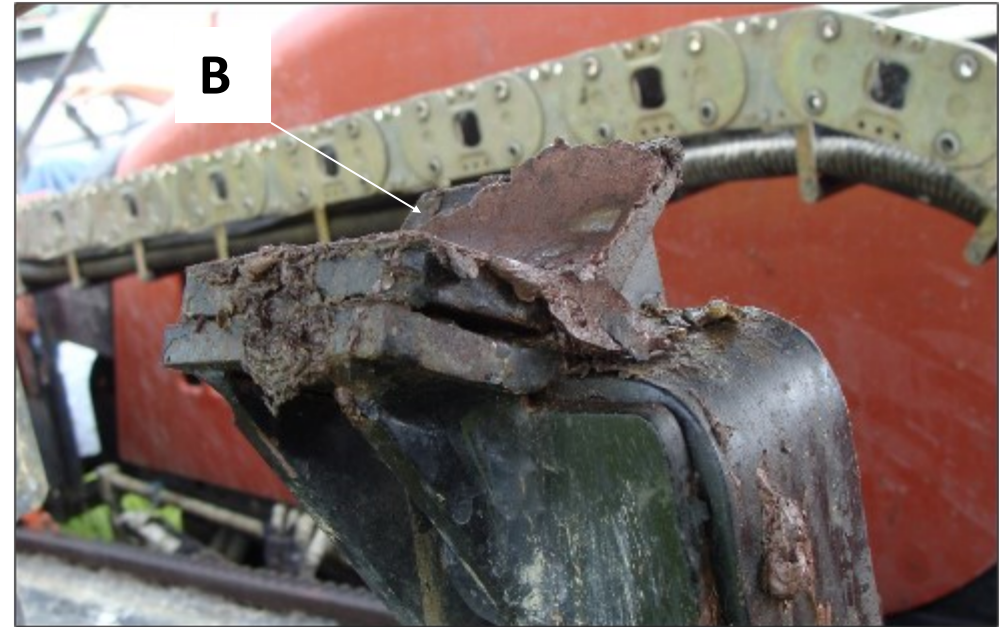
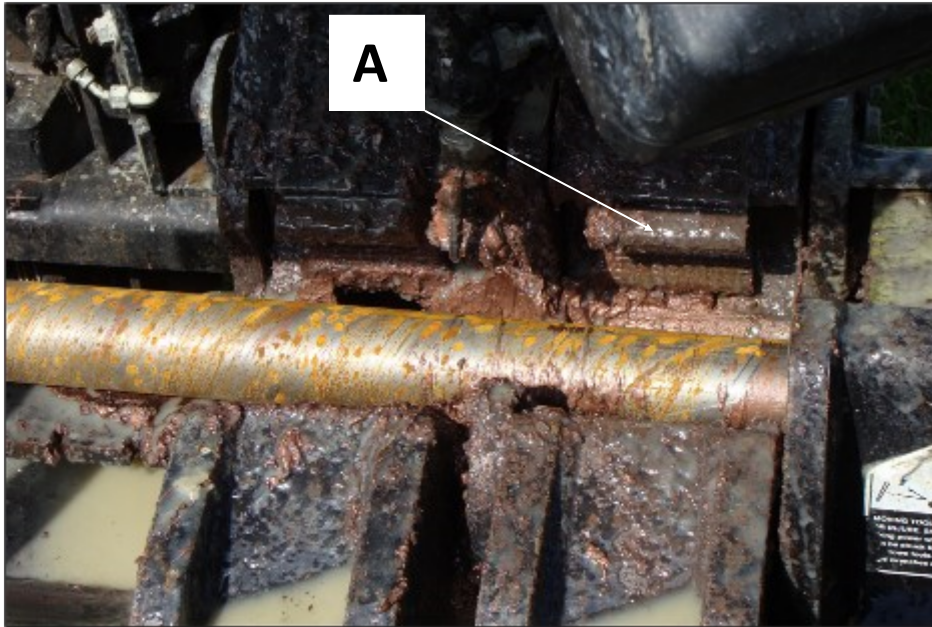

Items needed to complete HXT and HIWS1 conversion.

-[A] Set of 4 jaw blocks for use with 2.625" or 2.750" tool joints. Jaw block can be purchased from Hunting part number H0003.

-[B] To account for a smaller diameter tool joint and lifting pipe into rod-box, Hunting recommends welding 1/4" spacer plates on the two lift arms.

Ditch Witch® JT3020 Conversion (HIWS1)

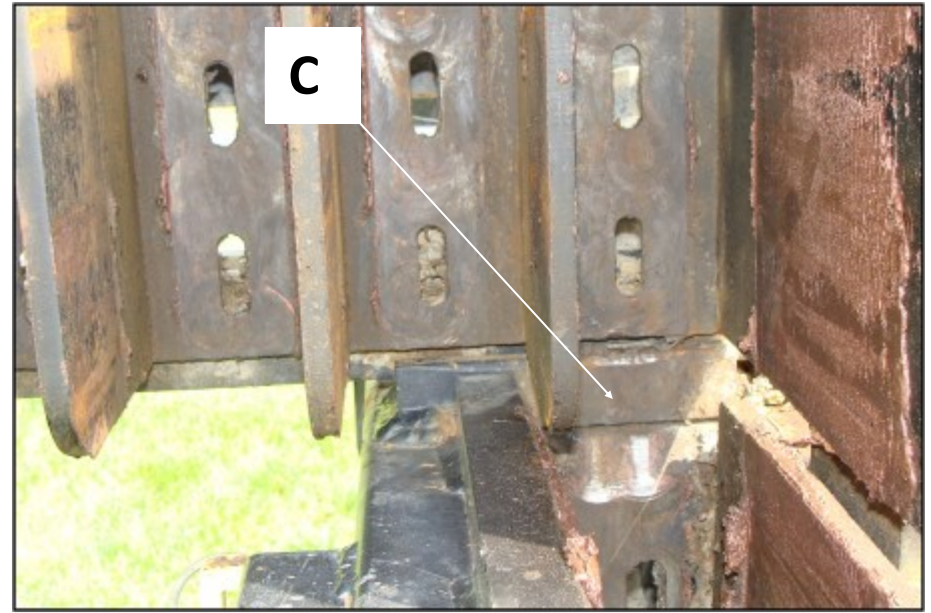
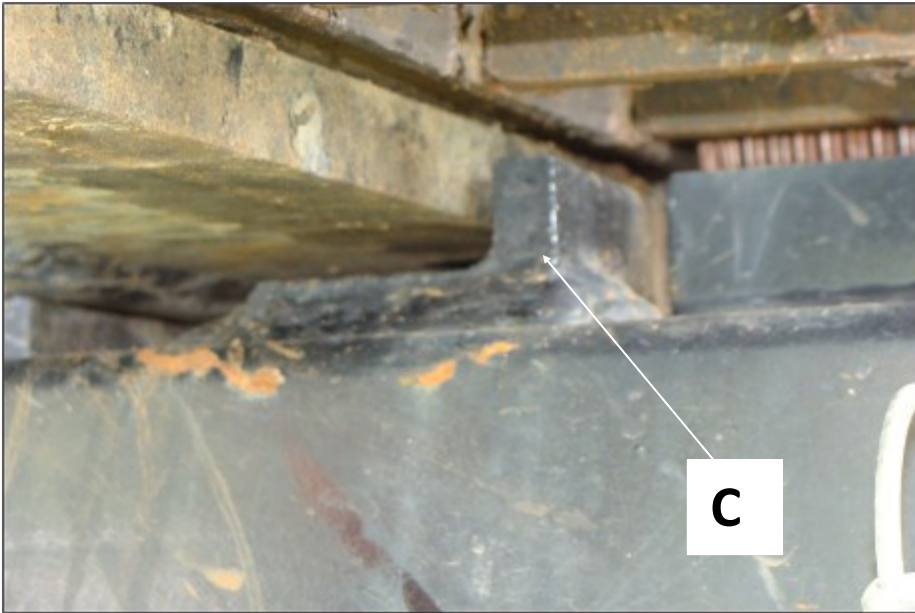

Additional items needed to complete HIWS1 “pin-down” conversion.

- Complete steps “A” and “B” from JT3020 HXT and HIWS1 conversion. Replace jaw blocks and add spacer plates to lifter arms.

-[C] Weld a vertical guide plate, extending the pipe guide into the pipe box. (A small piece of angle iron works best. With a pin-down configuration the nose of the pin can “catch” on the bottom of the rod box, when the pipe is lifted back into the rod box, therefore it is necessary to add a vertical guide plate.)

Ditch Witch® JT4020 Mach 1 Conversion (HXT)

Component Road Map

Rod Rack Capacity: 16/32

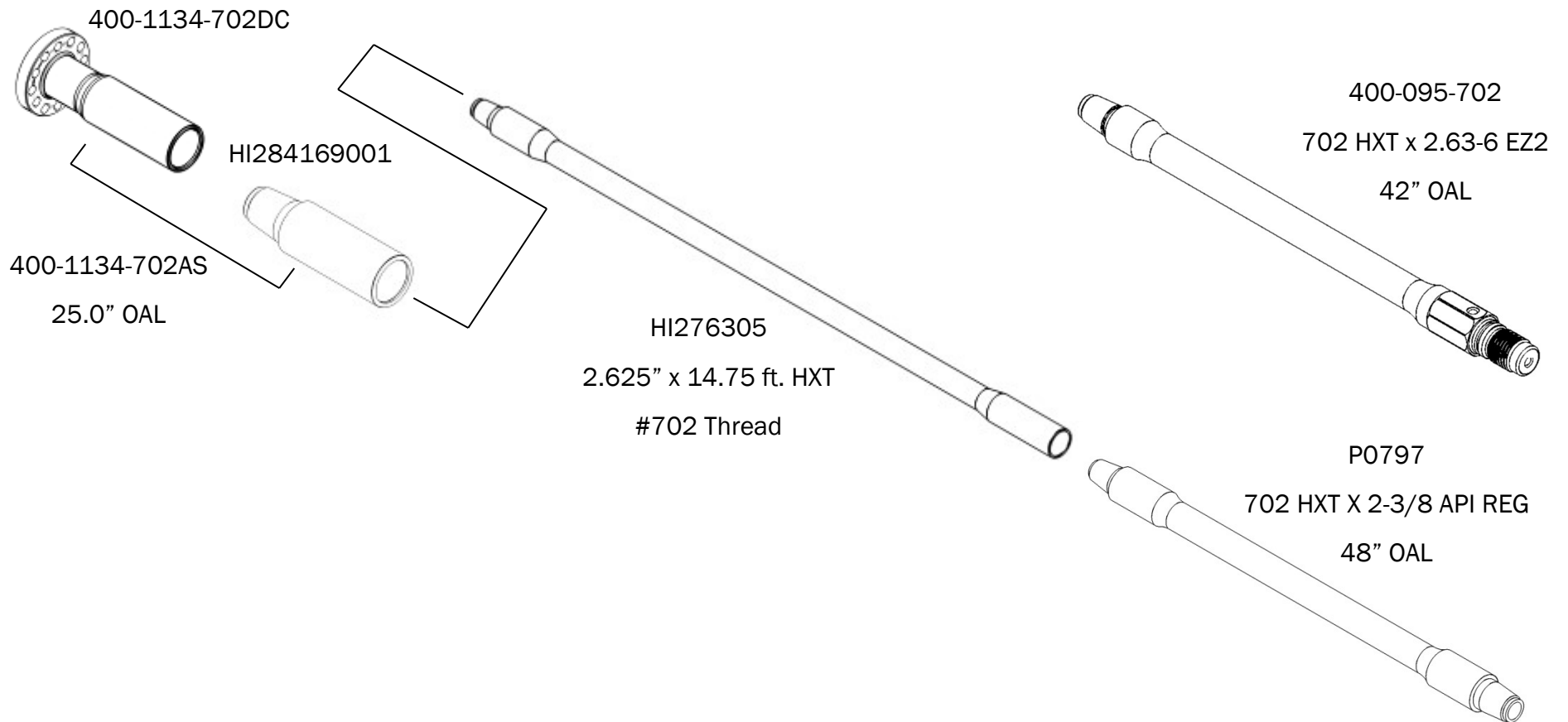

Ditch Witch® JT60 Conversion (HIWS1)

Component Road Map

Rod Rack Capacity: 16/28

400-2253*

SaverLoc #900Box



HI222452

2.875" x 15 ft. HIWS1

#900Thread



Ditch Witch® JT7020/JT8020/JT100 Conversion (HIWS1)

Component Road Map

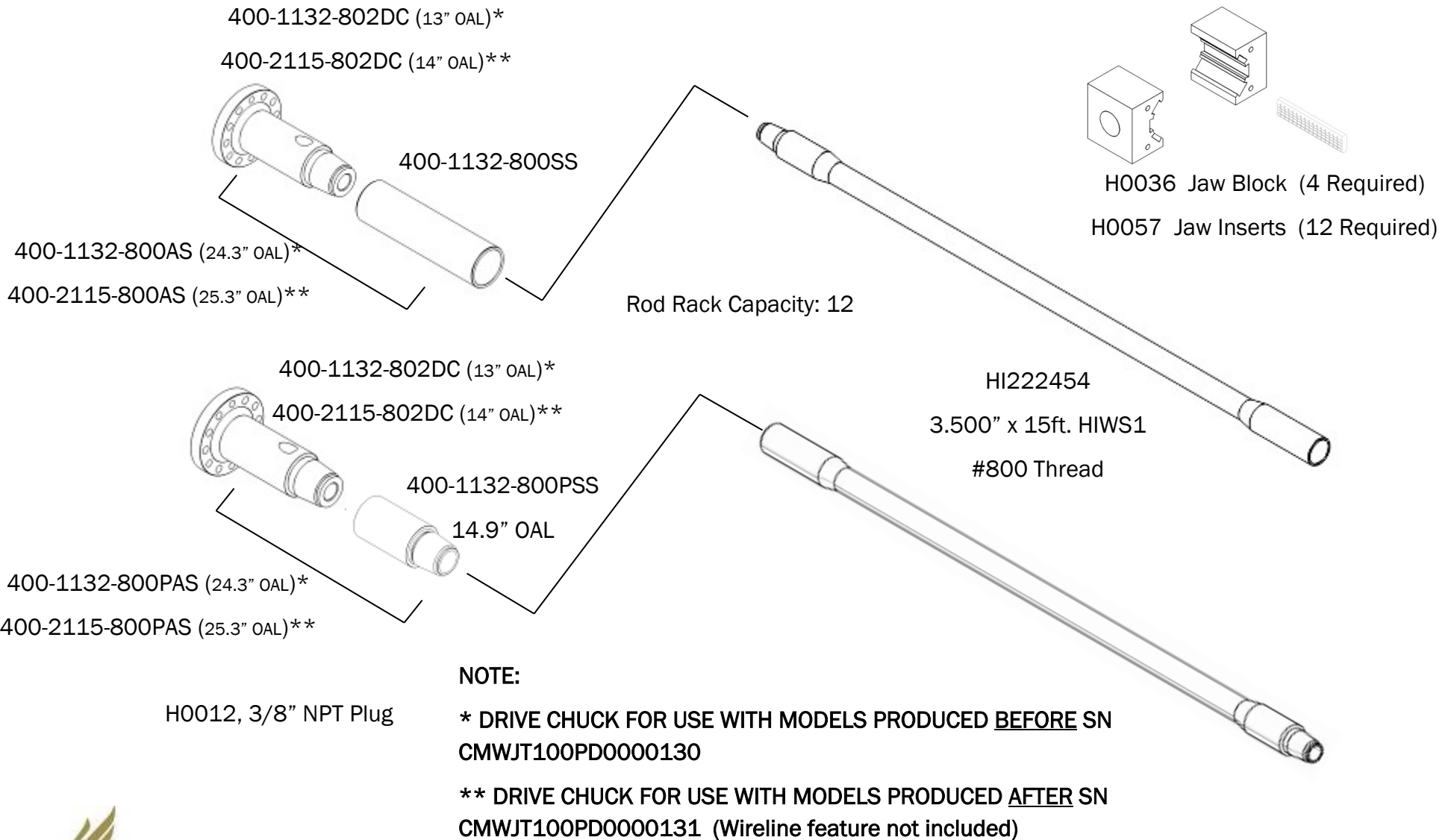

What Subsaver (Drive Chuck) do I have??: 400-1132-802DC (13" OAL)*

400-2115-802DC (14" OAL)**

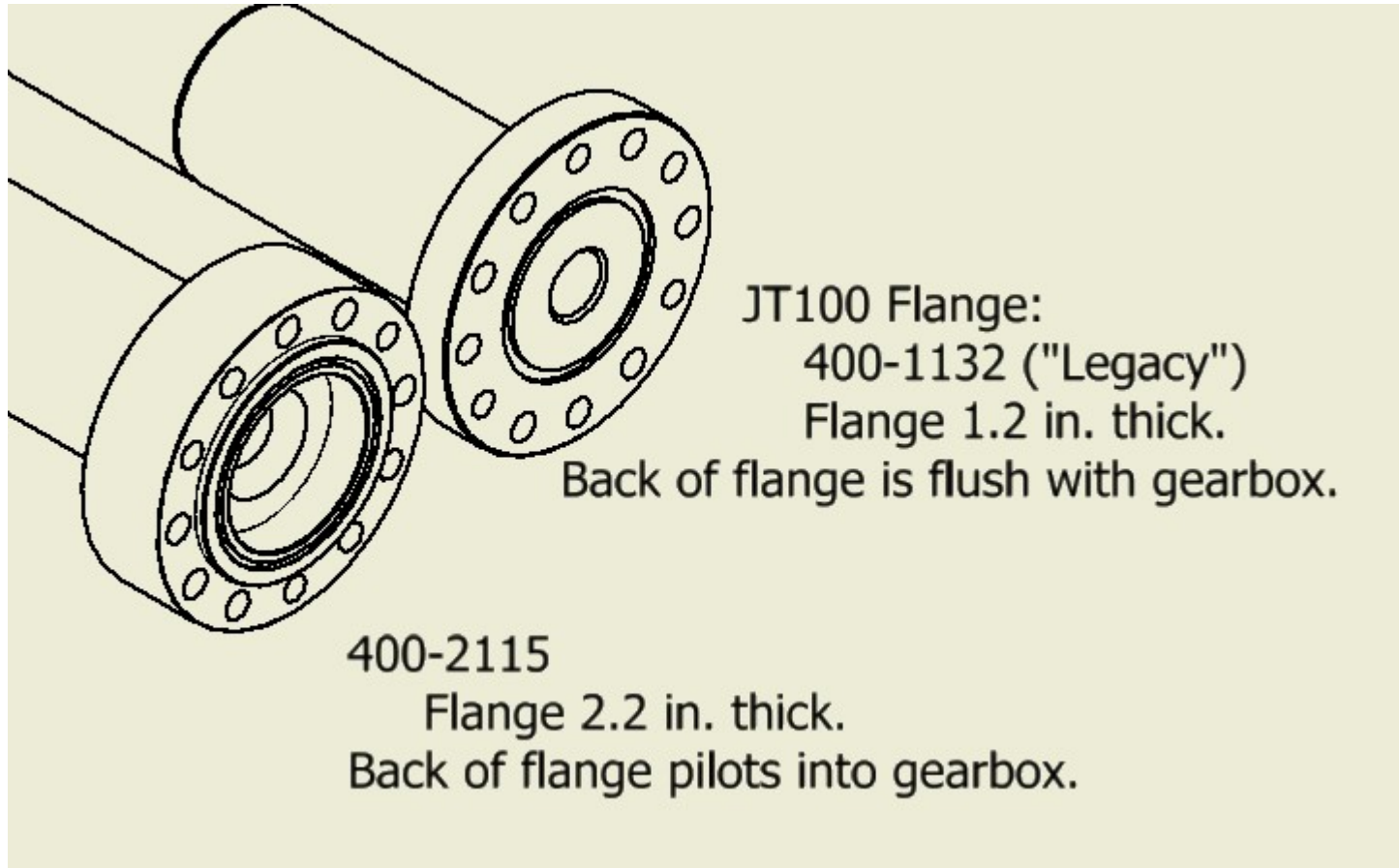

Ditch Witch® JT7020/JT8020/JT100 Conversion (HXT)

Component Road Map

Optional parts for BOX down conversion. The following parts will allow you to add your existing Ditch Witch pipe to the string when your bore distance exceeds the number of HXT rods you have.

400-1132-802DC (13" OAL)*

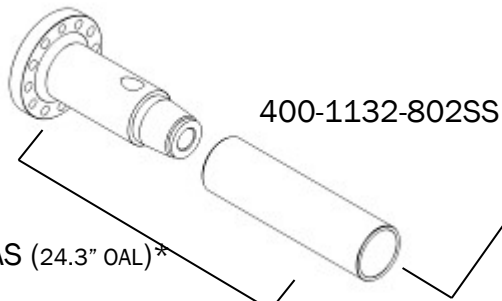

400-1132-802SS

400-1132-802AS (24.3" OAL)*

400-2115-802AS (25.3" OAL)**

Rod Rack Capacity: 12

P0848* 14.9" OAL ADAPTER (JT100 BOX X 802 BOX)

P0849* 13.0" OAL SAVER SUB (802 BOX X JT100 PIN)

(CALL FOR PRICING) P0847* 57" OAL TRANSITION ROD
802 PIN X JT100 PIN

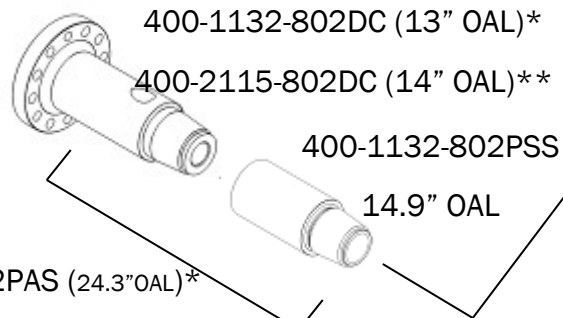

400-1132-802DC (13" OAL)*

400-2115-802DC (14" OAL)**

400-1132-802PSS

14.9" OAL

400-1132-802PAS (24.3" OAL)*

400-2115-802PAS (25.3" OAL)**

H0012, 3/8" NPT Plug

HI350802015

3.500" x 15ft. HXT

#802 Thread

P0870

Pulling Eye

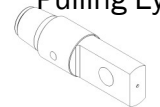

P0871

Pulling Eye

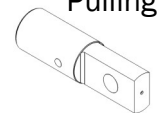

NOTE:

* DRIVE CHUCK FOR USE WITH MODELS PRODUCED BEFORE SN CMWJT100PD0000130

** DRIVE CHUCK FOR USE WITH MODELS PRODUCED AFTER SN CMWJT100PD0000131 (Wireline feature not included)

(*) indicates non stocking item



Ditch Witch® JT7020/JT8020/JT100 All Terrain Conversion

Component Road Map

This part is not a standard stocking item. Lead time is typically 3 weeks. See note below about modifying your existing sub.

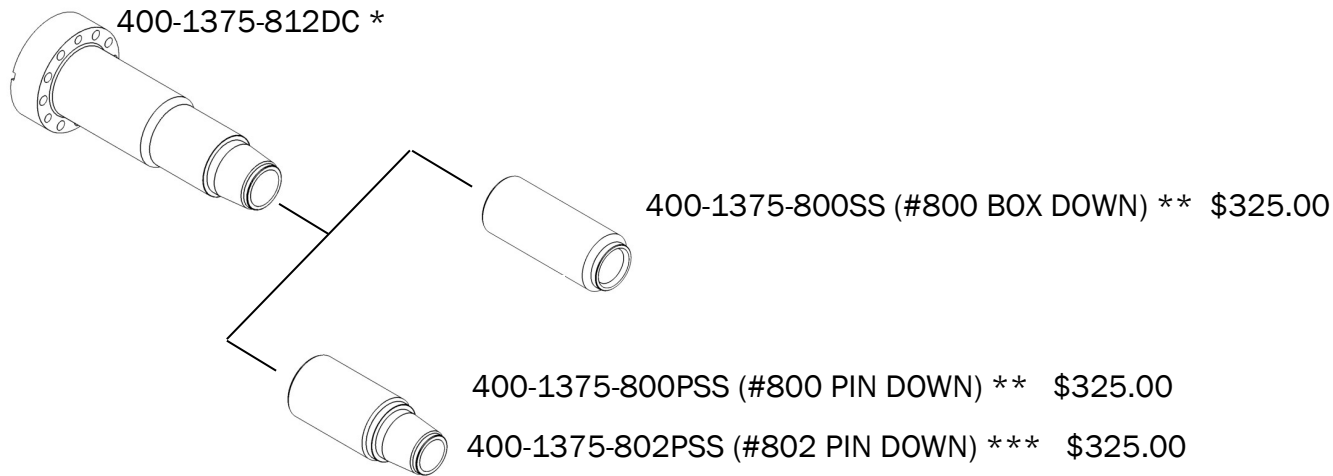

* YOUR EXISTING ALL TERRAIIN SAVER-SUB CAN BE MODIFIED TO ACCECPT ONE OF THE FOUR AVAILABLE SUBS. COST FOR THIS SERVICE IS \$250 PLUS SHIPPING AND HANDLING. TURN AROUND TIME IS TYPICALLY ONE WEEK ONCE WE RECEIVE THE EXISTING SAVER-SUB

Contact your Hunting representative for assistance with this service.

** FOUR (4) H0036 JAW BLOCKS ARE REQUIRED FOR THIS CONVERSION



Ditch Witch® Conversions



General note about Ditch Witch conversions

- Drill rigs with pipe locator switches (prox switch) may need to be adjusted due to Hunting drill rod diameters being different than standard Ditch Witch rod. Adjustment screws are located on switch mounting bracket. Pictures on the left are shown as an example and may not represent your exact rig.
- When converting a drill rig to run the pipe “PIN down” the automated greasers will need to be adjusted. If the machine has both upper and lower greaser, the upper greaser will need to be disconnected (reference photo above).
- Any drill rig that has “auto-makeup”, you may need to reset the parameters to compensate for the difference between the pitch of the Hunting thread vs. the pitch of the Ditch Witch thread. These parameters can only be reset by the Ditch Witch service mechanic at your local dealership.

Starter Rod /Transition Rod Accessories

Starter Rod/Transition Rod Components

JT5 1.31-6 M EZ2

369-319, EZ Protector Cap

H0034, M8-1.25 X 12mm Cap Screw

H0018, O-Ring (025 D90 Poly)

JT922 1.63-6MEZ2

111-092, EZ Protector Cap

H0005, M10-1.50 X 12mm Cap Screw

H0008, O-Ring (029 D90 Poly)

JT1220 1.88-6MEZ3

159-574, EZ Protector Cap

H0006, M10-1.50 X 16mm Cap Screw

H0009, O-Ring (223 D90 Buna)

JT2020 2.00-6MEZ2

369-271, EZ Protector Cap

H0007, M12-1.75 X 20mm Cap Screw

H0010, O-Ring (032 D90 Poly)

Starter Rod/Transition Rod Components

111-094, EZ Protector Cap

H0006, M10-1.50 X 16mm Cap Screw

H0011, O-Ring (137 D90 Poly)

JT4020 2.63-6MEZ2

369-345, EZ Protector Cap

H0037, M16-2.00 x 20mm Cap Screw

H0038, O-Ring (143 D90 Poly)

H0004, 1/2"-13 X 1/2" SHCS

Vermeer Starter Rod Cap Screw

Use with 2.125" LPT

H0014, 3/8"-16 X 1.2" SHCS

Vermeer Starter Rod Cap Screw

Use with 1.625" LPT